

BEO-3500M

350 Watt

- Complies with IEC/EN60601-1 – 3rd Edition
- Fanless operation
- Extremely compact design

The power supply series BEO-3500M is characterized by high performance and small dimensions. Thanks to its high efficiency it provides up to 350 watts without the necessity for any active cooling. Additionally it is equipped with +5V_{sb}, auxiliary voltage, a remote On/Off function and load-sense connections for output voltage adjustment. High quality of the installed parts and a superior circuit design guarantee maximum reliability and long service life.



NEW



Technical data	
Input voltage	90...264 V AC, active PFC
Input frequency	47...63 Hz
Input current	5 A (115 VAC), 2 A (230 VAC)
Inrush current	<50 A (240 VAC)
Efficiency	89...93 % depending on model
Standby consumption	<2 W at 0 A load
Hold up time	App. 16 ms
Protection	Short circuit protection: Switch off with auto recovery Overvoltage protection: Switch off
Line regulation	±0.5 % at nominal load and input voltage change from 90 to 264 VAC
Load regulation	±1 % (A1, load step ±40 % related to 60 % nominal load)
Earth leakage current	<300 µA max.
Safety / EMC	TÜV (IEC/EN60601-1 3rd Edition), UL (UL60601-1), CE
Operating temperature	-20...+70°C
Derating	See diagram
MTBF	100 000 h at +25 °C according to MIL-HDBK-217F
Storage temperature	-40...+85°C
Operating humidity	5...93 % RH, non-condensing
Dimensions (WxDxH)	101.6 x 165 x 34 mm ±1 mm
Weight (net)	0.64 kg

Product specific data	
Remote sense	Adjustment range 0.5 V (CN5)
Max. operation height	3000 m
Adjustment range (VR)	±5 %
PSON	ATX compatible (CN5), Power on at bridge from PIN5 to PIN6

Optional accessory ▷▷▷ For detailed information please visit our website www.bicker.de and refer to the article number.

Article No.	Description
X1-024	AC input cable harness, 2-pole
X1-061	AC input cable harness, 3-pole

Article No.	Output	Output voltage	Output current			Ripple & Noise	Efficiency
			min	fanless	max load		
BEO-3505M	A1	+5 V	0 A	40 A	60 A	<100 mV _{SS}	89 %
	A2	+5 V _{sb}	0 A	0.3 A	0.3 A	<50 mV _{SS}	
	A3	+12 V _{fan}	0 A	0.3 A	0.3 A	<120 mV _{SS}	
BEO-3512M	A1	+12 V	0 A	25 A	29.2 A	<120 mV _{SS}	92 %
	A2	+5 V _{sb}	0 A	0.3 A	0.3 A	<50 mV _{SS}	
	A3	+12 V _{fan}	0 A	0.3 A	0.3 A	<120 mV _{SS}	
BEO-3524M	A1	+24 V	0 A	12.5 A	14.6 A	<240 mV _{SS}	93 %
	A2	+5 V _{sb}	0 A	0.3 A	0.3 A	<50 mV _{SS}	
	A3	+12 V _{fan}	0 A	0.3 A	0.3 A	<120 mV _{SS}	
BEO-3548M	A1	+48 V	0 A	6.25 A	7.3 A	<480 mV _{SS}	93 %
	A2	+5 V _{sb}	0 A	0.3 A	0.3 A	<50 mV _{SS}	
	A3	+12 V _{fan}	0 A	0.3 A	0.3 A	<120 mV _{SS}	

350 W continuous power with 10 CFM fan (-20...+50 °C). From +50...+70 °C 2.5% / K. Fanless operation see derating diagrams. Ripple and Noise was measured by a 20 MHz bandwidth limited oscilloscope with connected 100 nF and 47 µF capacitors at the output.

As a power component this PSU is for assembly purposes only and must not be operated in unassembled condition. The final assembly has to comply with the valid EMC and safety standards.

Derating BEO-3500M

350 W with 10 CFM fan

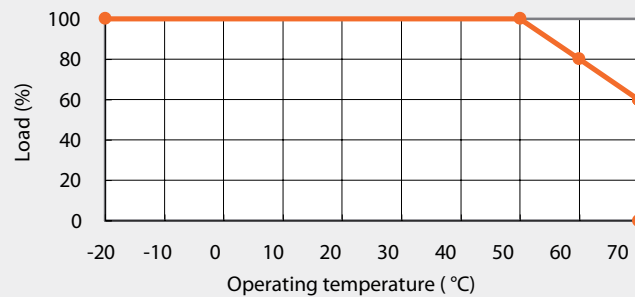

350 W with convection

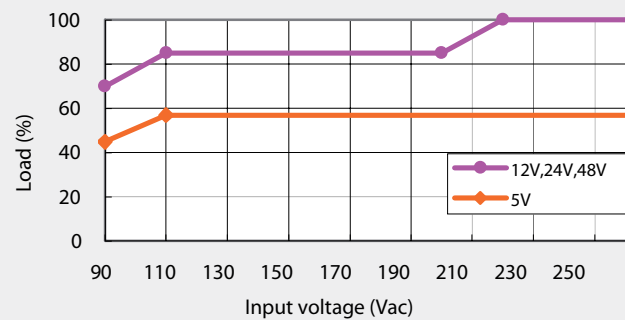

350 W with convection

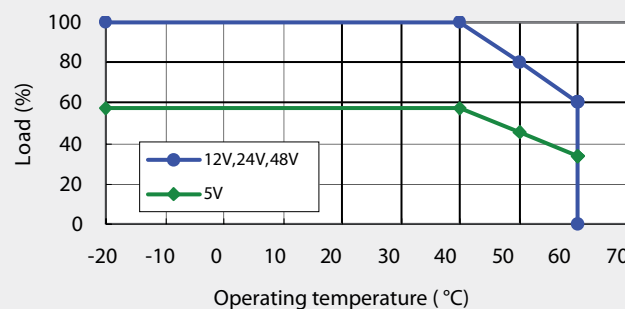

Drawing BEO-3500M

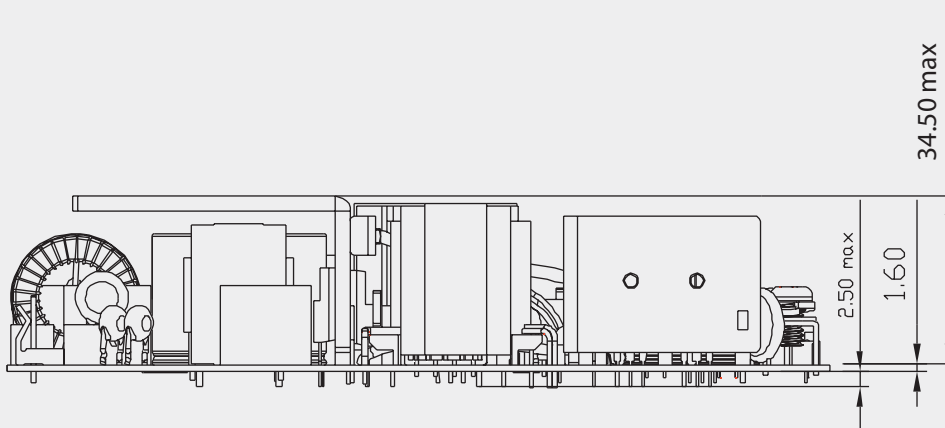
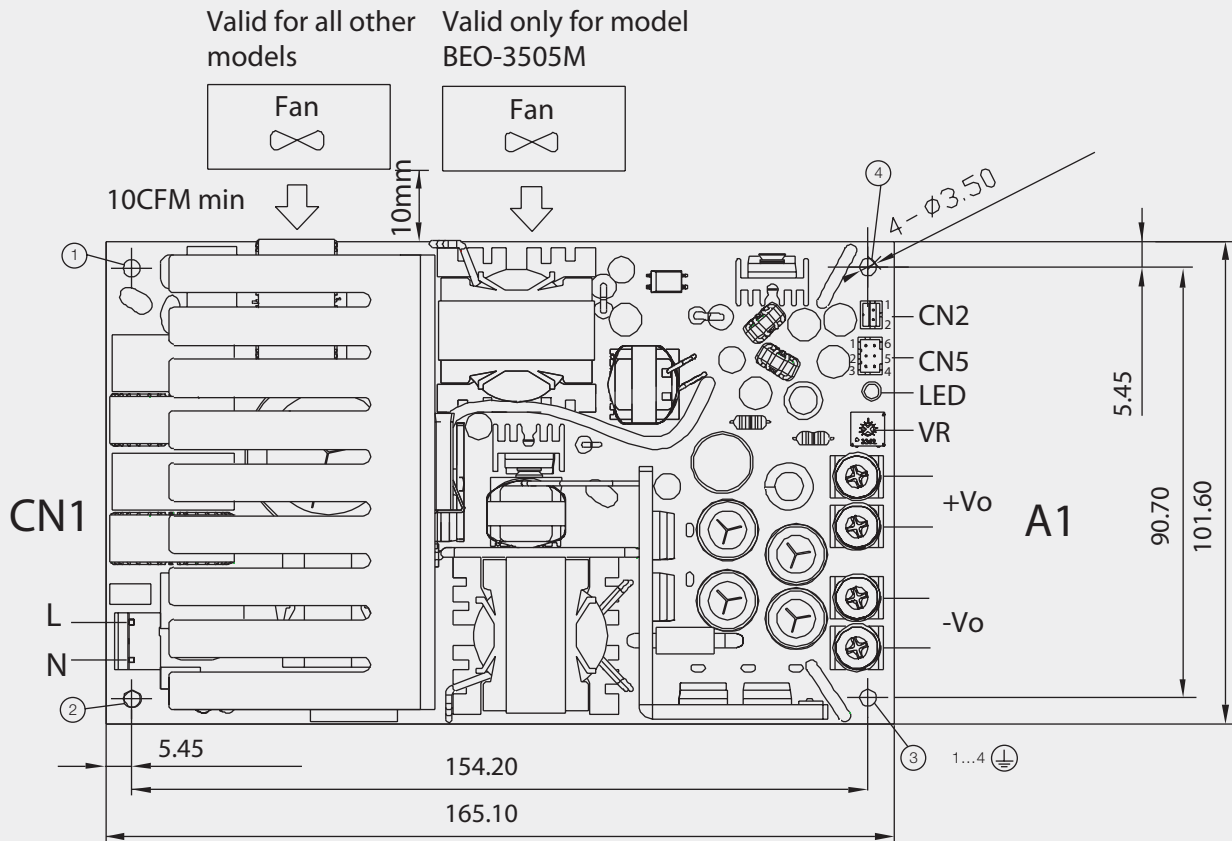

CN2

Pin	Function
1	FAN output+ (A3)
2	FAN output- (A3)

CN5

Pin	Function	Pin	Function
1	GND	4	-SENSE
2	+5Vsb (A2)	5	PSON
3	+SENSE	6	GND

Connectors:

CN1: AC input / Molex 5227 or equal

CN2: DC output / JST B 2B-PH-K or equal

CN5: DC output / Tyco 4-1470109-6 or equal

Toleranz ±1 mm

Power supplies

Specification is subject to change without notice. Errors excepted. Status as at: 27.04.2012